

- NOTES:**
 1. MATERIAL:
 2. MAXIMUM ROUGHNESS \sqrt{R} UNLESS SPECIFIED.
 3. REMOVE ALL BURRS AND SHARP EDGES UNLESS SPECIFIED.

Bottom of rotator probe with DIP platform

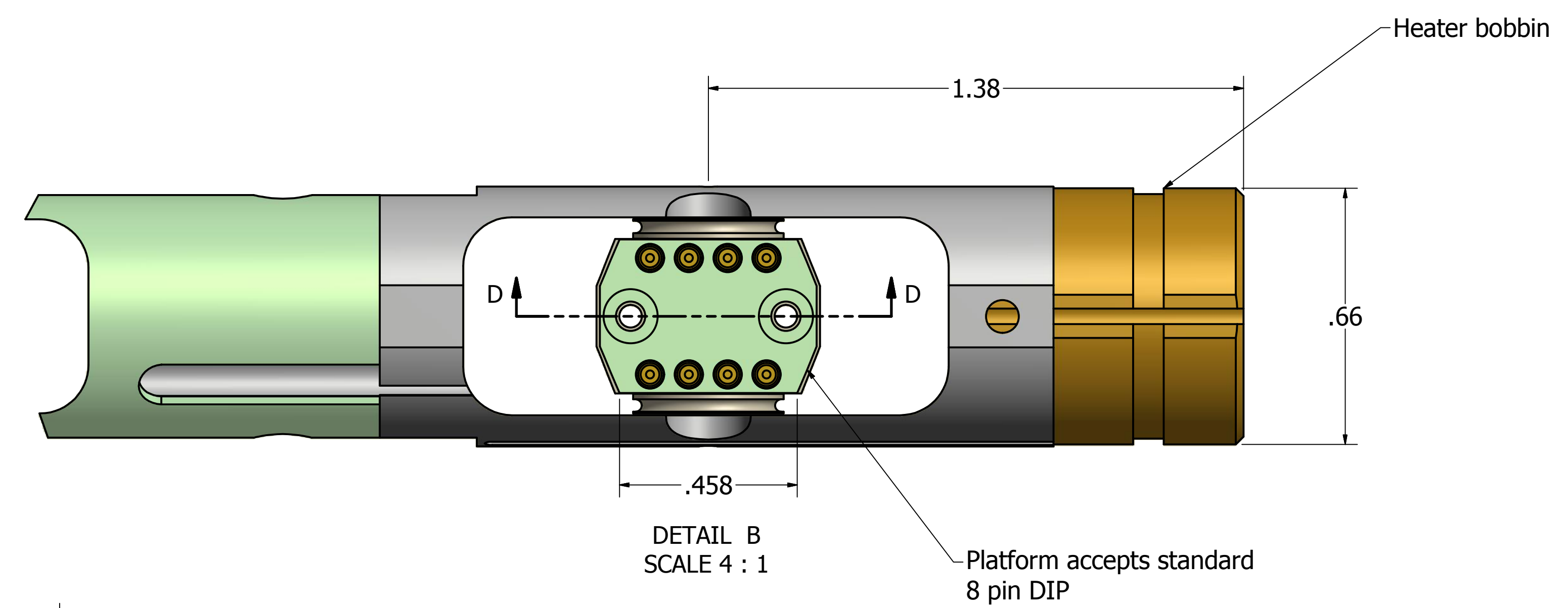

DETAIL B
 SCALE 4 : 1
 Platform accepts standard
 8 pin DIP

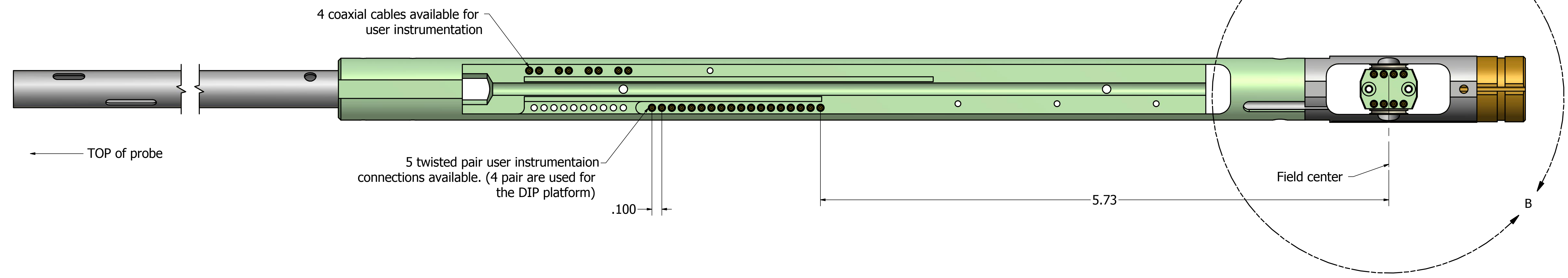
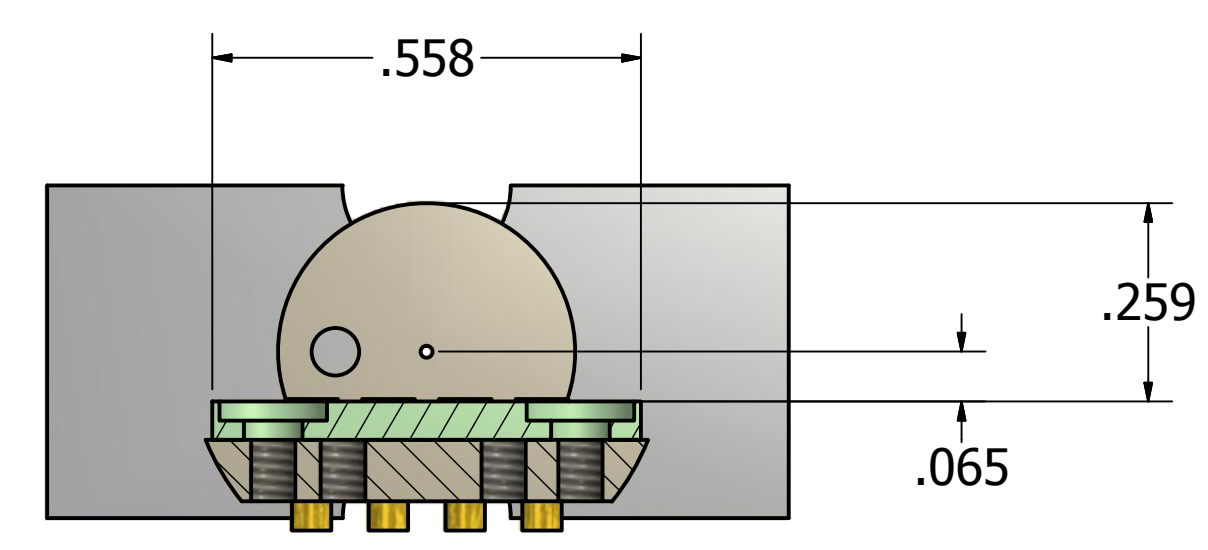

SECTION D-D
 SCALE 4 : 1

This drawing and the information it contains are both property of the Florida State University and are to be held by the recipient as confidential and are not to be transferred to any third party, used to make or furnish information for making any physical structure or any pictorial, graphic or verbal representation of any information contained herein or copied (unless supplied in productive form) without the express written consent of the Florida State University.

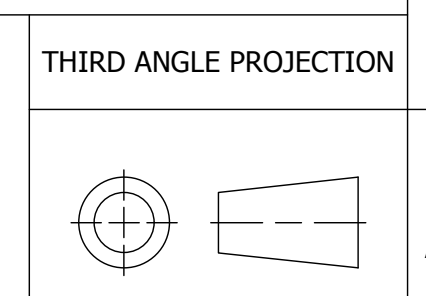

GENERAL TOLERANCES		PART MODEL FILENAME DIP rotator Nov_2012.iam		NATIONAL HIGH MAGNETIC FIELD LABORATORY 1800 E PAUL DIRAC DRIVE TALLAHASSEE, FLORIDA 32310		
1 PL DEC: ± 0.020	MODELED MAIER 11/14/2012	DESC		SIZE D	DWG NUMBER DIP rotator Nov_2012	
2 PL DEC: ± 0.010	DETAILED MAIER 11/14/2012	UNLESS OTHERWISE SPECIFIED, DIMENSIONS ARE IN INCHES. DO NOT SCALE DRAWING		SHT 1 OF 1		
3 PL DEC: ± 0.005	CHECKED	ANGLES: ± 1'				